

## NC Drill Chuck

### Features:

- Supplied with a spanner.

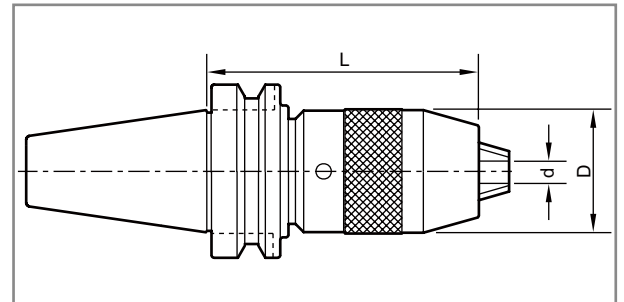

Taper Shank	Ordering Code	Type of Holder	d Capacity	D	L
BT30	330190-103	BT30-APU08-90	0-8	36.6	90
	-202	-APU13-105	1-13	51.5	105
BT40	340190-102	BT40-APU08-90	0-8	36.3	90
	-202	-APU13-90	1-13	51.5	90
	-302	-APU16-115	3-16	58	115
BT50	350190-202	BT50-APU13-125	1-13	51.5	125
	-302	-APU16-135	3-16	58	135

## Power Drill Chuck

### Features:

- For Clockwise and Counter clockwise rotation of cutting tools.
- High clamping power, high accuracy.
- Supplied with a spanner.

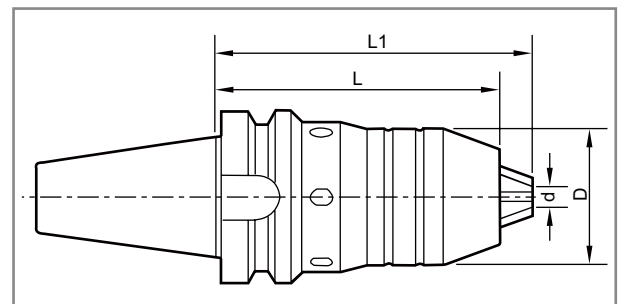

Taper Shank	Ordering Code	Type of Holder	d Capacity	D	L	L1
BT30	330192-102	BT30-SPH08-83	0-8	37.5	83	92/83
	-202	-SPH13-102	0-13	50	102	115/102
BT40	340192-102	BT40-SPH08-87	0-8	37.5	87	96/87
	-202	-SPH13-102	0-13	50	102	115/102
	-302	-SPH16-108.5	3-16	57	108.5	121.5/108.5
BT50	350192-102	BT50-SPH08-98	0-8	37.5	98	106/98
	-202	-SPH13-115.5	0-13	50	115.5	126.2/115.5
	-302	-SPH16-119.5	3-16	57	119.5	132.2/119.5