

Side Lock Holder

Features:

- For clamping the End Mill with DIN 1835 Form B shank.
- The End Mill Holders are supplied with set screws which are made according to DIN 1835 B-M14x16.

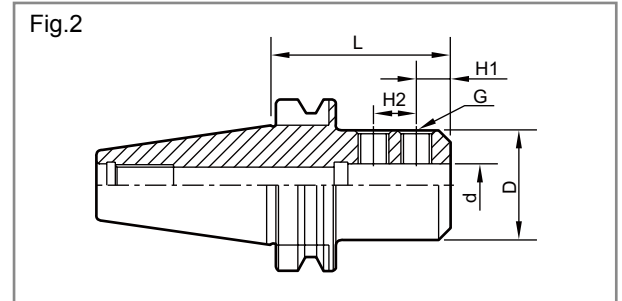
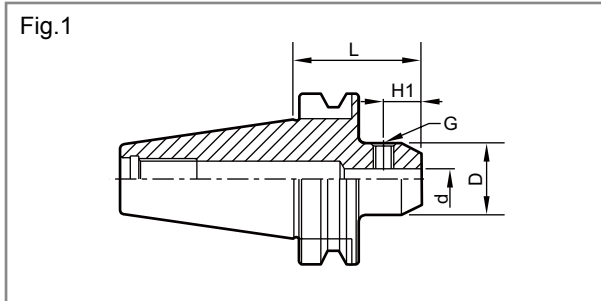

| Taper Shank | Ordering Code | Type of Holder | Fig. | d | L | D | H1 | H2 | G |
|-------------|---------------|----------------|------|----|-----|----|------|----|-----|
| BT30 | 330160-062 | BT30-SL6-60 | 1 | 6 | 60 | 25 | 18 | - | M6 |
| | -082 | -SL8-60 | | 8 | | 28 | 18 | | M8 |
| | -102 | -SL10-60 | | 10 | | 35 | 20 | | M10 |
| | -122 | -SL12-60 | | 12 | | 42 | 22.5 | | M12 |
| | -161 | -SL16-70 | | 16 | 75 | 48 | 24 | | M14 |
| | -202 | -SL20-75 | | 20 | | 52 | 25 | | M16 |
| BT40 | 340160-062 | BT40-SL6-75 | 1 | 6 | 75 | 25 | 18 | - | M6 |
| | -082 | -SL8-75 | | 8 | | 28 | 18 | | M8 |
| | -102 | -SL10-75 | | 10 | | 35 | 20 | | M10 |
| | -122 | -SL12-75 | | 12 | | 42 | 22.5 | | M12 |
| | -162 | -SL16-75 | | 16 | | 48 | 24 | | M14 |
| | -202 | -SL20-75 | | 20 | | 52 | 25 | | M16 |
| | -252 | -SL25-90 | 2 | 25 | 90 | 60 | 24 | 25 | M16 |
| | -322 | -SL32-90 | | 32 | | | | 28 | M16 |
| BT50 | 350160-062 | BT50-SL6-105 | 1 | 6 | 105 | 25 | 18 | - | M6 |
| | -082 | -SL8-105 | | 8 | | 28 | 18 | | M8 |
| | -102 | -SL10-105 | | 10 | | 35 | 20 | | M10 |
| | -122 | -SL12-105 | | 12 | | 42 | 22.5 | | M12 |
| | -162 | -SL16-105 | | 16 | | 48 | 24 | | M14 |
| | -202 | -SL20-105 | | 20 | | 52 | 25 | | M16 |
| | -252 | -SL25-105 | 2 | 25 | 105 | 60 | 24 | 25 | M16 |
| | -322 | -SL32-105 | | 32 | | | | 72 | 28 |
| | -402 | -SL40-120 | | 40 | 120 | 80 | 27 | 32 | |
| | -422 | -SL42-120 | | 42 | | | 30 | | |