

ER Spring Collets

Features:

- Case hardened steel guarantees long operating life and elasticity of collets.
- All collets are precisely ground according to DIN ISO15488:2006-1*.
- Class 1 for high precision tool holding, order code: 300100-612-AA
- Sealed through coolant type collets are available. Order code: 300100-612H



ER11		ER20		ER25		ER32		ER40	
Ordering Code	Range (mm)	Ordering Code	Range (mm)	Ordering Code	Range (mm)	Ordering Code	Range (mm)	Ordering Code	Range (mm)
300100-201	1.0-0.5	300100-402	2-1	300100-502	2-1	300100-603	3-2	300100-704	4-3
-251	1.5-1.0	-403	3-2	-503	3-2	-604	4-3	-705	5-4
-202	2.0-1.5	-404	4-3	-504	4-3	-605	5-4	-706	6-5
-252	2.5-2.0	-405	5-4	-505	5-4	-606	6-5	-707	7-6
-203	3.0-2.5	-406	6-5	-506	6-5	-607	7-6	-708	8-7
-253	3.5-3.0	-407	7-6	-507	7-6	-608	8-7	-709	9-8
-204	4.0-3.5	-408	8-7	-508	8-7	-609	9-8	-710	10-9
-254	4.5-4.0	-409	9-8	-509	9-8	-610	10-9	-711	11-10
-205	5.0-4.5	-410	10-9	-510	10-9	-611	11-10	-712	12-11
-255	5.5-5.0	-411	11-10	-511	11-10	-612	12-11	-713	13-12
-206	6.0-5.5	-412	12-11	-512	12-11	-613	13-12	-714	14-13
-256	6.5-6.0	-413	13-12	-513	13-12	-614	14-13	-715	15-14
-207	7.0-6.5			-514	14-13	-615	15-14	-716	16-15
ER16				-515	15-14	-616	16-15	-717	17-16
				-516	16-15	-617	17-16	-718	18-17
300100-301	1-0.5					-618	18-17	-719	19-18
-302	2-1					-619	19-18	-720	20-19
-303	3-2					-620	20-19	-721	21-20
-304	4-3							-722	22-21
-305	5-4							-723	23-22
-306	6-5							-724	24-23
-307	7-6							-725	25-24
-308	8-7							-726	26-25
-309	9-8								
-310	10-9								

Collet Dimensions

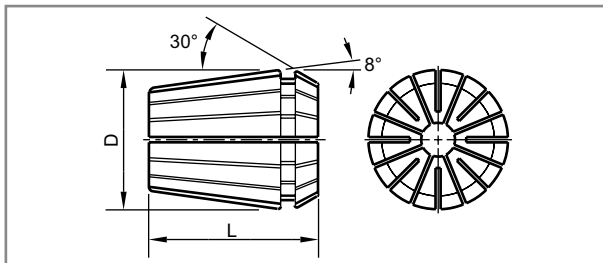

Type	ER11	ER16	ER20	ER25	ER32	ER40
D	11.5	17	21	26	33	41
L	18	27	31	35	40	46

Concentricity of Collet DIN ISO 15488:2006-01

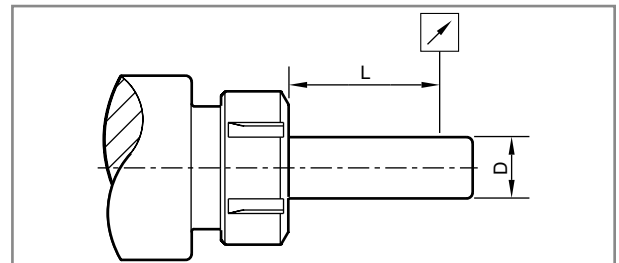

L(mm)	D(mm)	class 2	class 1
		0-300100	0-300100-A
6	1.0 - 1.6	0.015	0.010
10	1.6 - 3.9		
16	3.0 - 6.0		
25	6.0 - 10	0.020	0.015
40	10.0 - 18		
50	18.0 - 26.9		